

**SCOPE:** Internal waterproofing of new or existing below ground wall and slab structures subject to ground moisture or hydrostatic pressure.

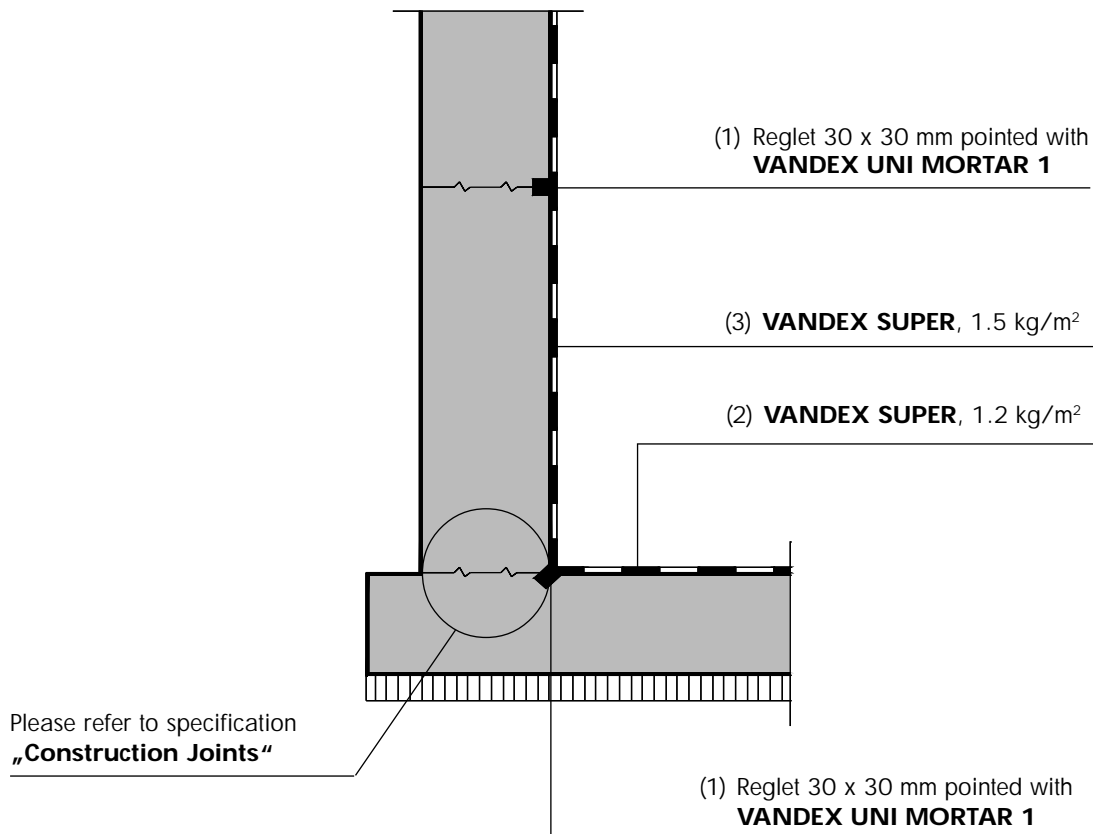

## Application Instructions:

- 1.) Chase out a reglet approx. 30 x 30 mm along the construction joints. Fill the cleaned reglet with VANDEX UNI MORTAR 1 at the rate of approx. 1.8 kg/linear meter, such that it finishes flush with the internal surface.
- 2.) Apply one coat of VANDEX SUPER, at the rate of 1.2 kg/m<sup>2</sup> to slab surface.
- 3.) To the interior wall surface apply two coats of VANDEX SUPER at the rate of 0.75 kg/m<sup>2</sup> each.

The information contained herein is based on our longterm experience and the best of our knowledge. We can, however, make no guarantee since for a successful outcome, all circumstances in an individual case must be taken into consideration. Indications of quantities required are only averages which in certain cases might be greater.