

**SCOPE:** Waterproofing of potable water reservoirs, above or below ground

(5) **VANDEX SUPER**, 1.2 kg/m<sup>2</sup>

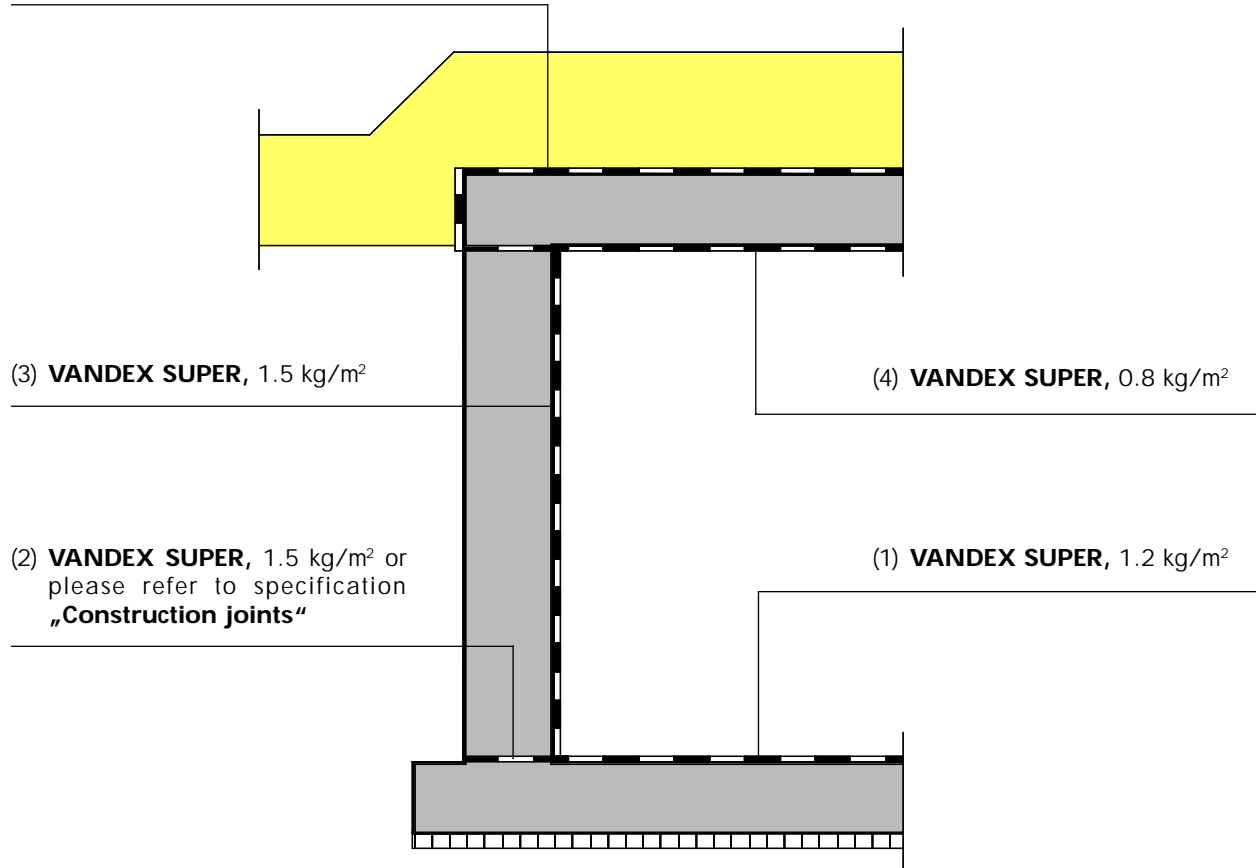

(3) **VANDEX SUPER**, 1.5 kg/m<sup>2</sup>

(4) **VANDEX SUPER**, 0.8 kg/m<sup>2</sup>

(2) **VANDEX SUPER**, 1.5 kg/m<sup>2</sup> or please refer to specification „Construction joints“

(1) **VANDEX SUPER**, 1.2 kg/m<sup>2</sup>

## Application Instructions:

- 1.) Apply one coat of VANDEX SUPER, at the rate of 1.2 kg/m<sup>2</sup> to floor.
- 2.) To all construction joints, apply VANDEX SUPER, at the rate of 1.5 kg/m<sup>2</sup> or in accordance with the specification „Construction joints“
- 3.) Apply two coats of VANDEX SUPER at the total rate of 1.5 kg/m<sup>2</sup> to the walls. Apply the second coat whilst the first is still green.
- 4.) Apply one coat of VANDEX SUPER, at the rate of 0.8 kg/m<sup>2</sup> to the ceiling.
- 5.) If the structure is situated below ground, first apply VANDEX SUPER, at the rate of 1.2 kg/m<sup>2</sup> to the roof.

## Alternatives:

- Where a particularly smooth surface is required apply two coats of VANDEX BB 75 at the rate of 3 kg/m<sup>2</sup> each at steps 1, 2 & 3. At step 4 apply one coat of VANDEX BB 75 at the rate of 3 kg/m<sup>2</sup>.
- Where a better aesthetic quality is required, apply two coats of VANDEX BB WHITE at the rate of 3 kg/m<sup>2</sup> each at steps 1, 2 & 3. At step 4 apply one coat of VANDEX BB WHITE at the rate of 3 kg/m<sup>2</sup>.

The information contained herein is based on our longterm experience and the best of our knowledge. We can, however, make no guarantee since for a successful outcome, all circumstances in an individual case must be taken into consideration. Indications of quantities required are only averages which in certain cases might be greater.