

SCOPE: Refurbishment of potable water reservoirs, above or below ground exposed to increased microbiological attack

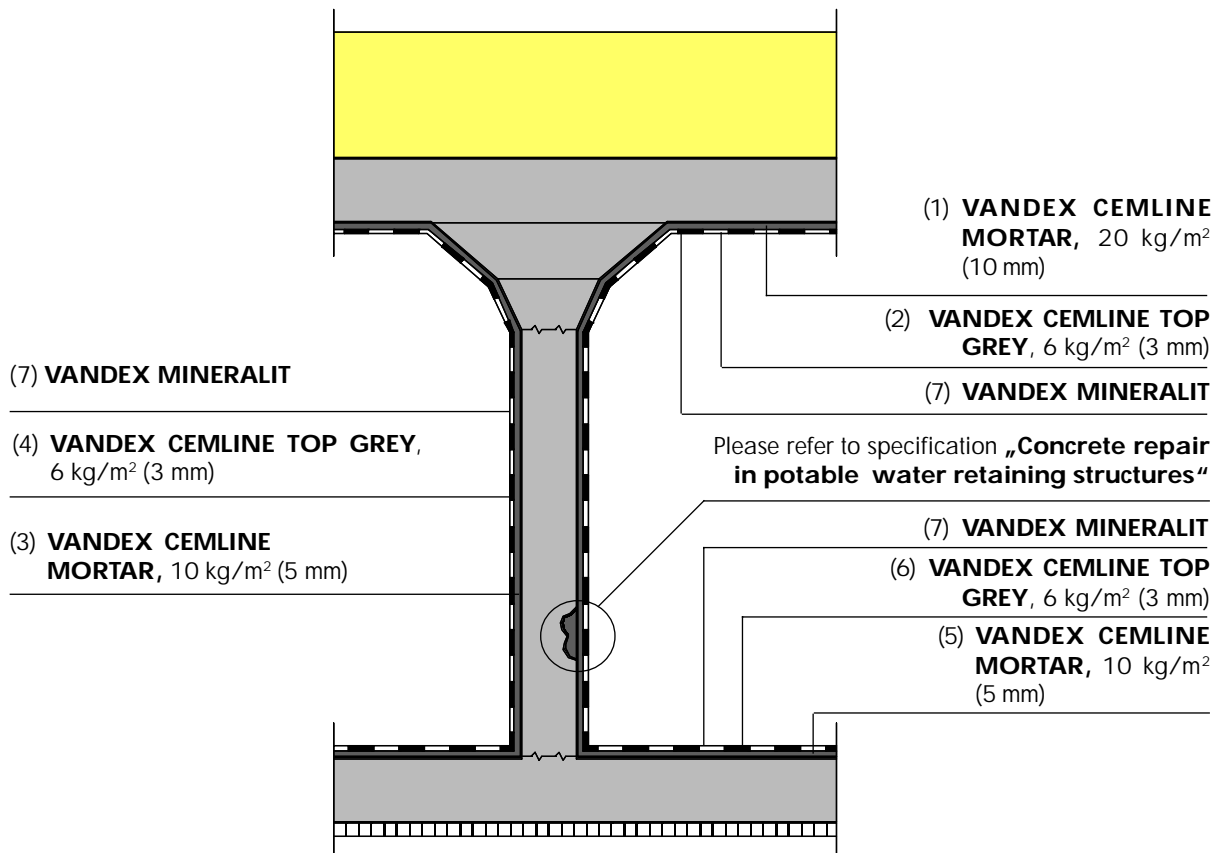

Application Instructions:

- 1.) Ceiling:
Apply one coat of VANDEX CEMLINE MORTAR, at the rate of 20 kg/m² (10 mm), as a levelling mortar and to increase concrete cover to the reinforcement.
- 2.) As final protective coat, apply two coats of VANDEX CEMLINE TOP GREY, at the total rate of 6 kg/m² (3mm). To manage condensation, VANDEX CEMLINE TOP GREY can be applied as mini stalactites.
- 3.) Vertical surfaces:
Apply one coat of VANDEX CEMLINE MORTAR, at the rate of 10 kg/m² (5 mm), as a levelling mortar and to increase concrete cover to the reinforcement.
- 4.) As final protective coat, apply two coats of VANDEX CEMLINE TOP GREY, at the total rate of 6 kg/m² (3mm).
- 5.) Slab:
Apply one coat of VANDEX CEMLINE MORTAR, at the rate of 10 kg/m² (5 mm), as a levelling mortar and to increase concrete cover to the reinforcement.
- 6.) For a smooth surface finish, apply two coats of VANDEX CEMLINE TOP GREY, at the total rate of 6 kg/m² (3mm).
- 7.) As a surface hardening agent, apply VANDEX MINERALIT, at the rate of 150 - 250 g/m².

Alternative:

Where an improved aesthetic quality is required, apply two coats of VANDEX CEMLINE TOP WHITE, at the total rate of 6 kg/m² (3 mm) instead of VANDEX CEMLINE TOP GREY.

The information contained herein is based on our longterm experience and the best of our knowledge. We can, however, make no guarantee since for a successful outcome, all circumstances in an individual case must be taken into consideration. Indications of quantities required are only averages which in certain cases might be greater.